

## MULTI-JET

- EEC Class B Approved
- Working Pressure: 16 Bar
- Dry Dial
- For cold (30°C) or hot (90°C) water
- Brass body
- Powder Epoxy Coated
- Protected Rollers
- 5 Black rollers (Cubic Metre)
- 3 Red rollers (Submultiples)
- Pointer minimum reading 0.05 litres
- Sensitivity index
- Real performances exceed EEC & ISO standards
- Counter perfectly sealed (hermetic)



### TECHNICAL DATA

Delta Flowtech Multi-Jet Meters  
Cold (30°C)

Part No	Dn Size	Max Flow <i>m<sup>3</sup>/h</i>	Nominal Flow <i>m<sup>3</sup>/h</i>	Trans. Flow <i>L/hr</i>	Min. Flow <i>L/hr</i>	Pulse Options* <i>litres per pulse</i>
D15W	15	3	1.5	120	30	1-10-100
D20W	20	5	2.5	200	50	1-10-100
D25W	25	7	3.5	270	70	10-100
D32W	32	12	6.0	460	120	10-100
D40W	40	20	10	750	200	10-100
D50W <sub>screwed</sub>	50	30	15	1050	300	10-100
D50WF <sub>flanged</sub>	50	30	15	1050	300	10-100

Part No	Dn Size <i>mm</i>	Body Length <i>mm</i>	Length Couplings	Height	Width	Weight
D15W	1/2"(DN15)	145	230	105	100	1.6
D20W	3/4"(DN20)	190	280	106	100	1.8
D25W	1"(DN25)	260	370	115	104	2.7
D32W	1 1/4"(DN32)	260	375	115	105	2.9
D40W	1 1/2"(DN40)	300	420	148	125	6
D50W <sub>screwed</sub>	2"(DN50)	300	435	173	126	12
D50WF <sub>flanged</sub>	2"(DN50)	300	435	173	126	12

## TERMS OF REFERENCE:

- **Size (mm)** – Refers to inside bore diameter.
- **Max Flow Rate ( $Q$  m<sup>3</sup>/h)** – Refers to the emergency flow rate in the event of system failure. Damage may result.
- **Nominal Flow Rate ( $Q_N$  m<sup>3</sup>/h)** – Typical application for every day usage.
- **Transitional Flow Rate ( $Q_t$  m<sup>3</sup>/h)** – Point at which the flow rate is high enough to achieve a level of accurate measurement.
- **Minimum Flow Rate ( $Q_{min}$  m<sup>3</sup>/h)** – The absolute minimum flow required for the unit to function.
- **EEC Approved Class** – The EEC Classification system used to measure accuracy at very low flow rates.
- **Bolt Circle Centres** – Refers to distance between opposite bolt holes on the flange, taken centre to centre.

Please advise preferred pulsed output at time of ordering.

\*Other pulse options may be available – please consult our technical team.

Figures apply to both hot and cold meters.

When ordering please state whether for hot or cold use.

Pressure drops on all sizes are generally below 0.2 bar.

## DIMENSIONS

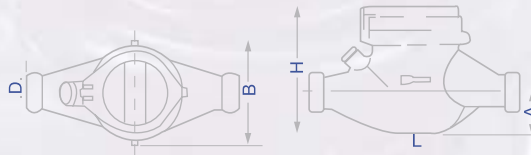

## TYPICAL ERROR CURVE

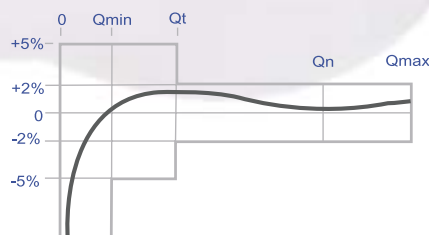

## MAX PRESSURE LOSS DIAGRAM

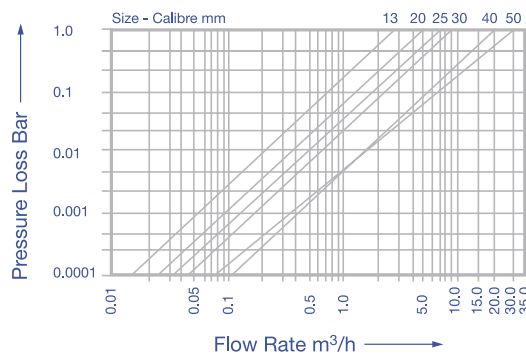

All sizes are approximate and are given for guidance only.  
Products and Specifications may be subject to change from those shown

